



St. Johnsbury

ROUTE 2B BRIDGE PROJECT



FOR IMMEDIATE RELEASE

**CONTACT: Francine Perkins
Project Outreach Coordinator
802-479-6994**

VTrans to Replace Route 2B Bridge in St. Johnsbury

Montpelier, VT - April 21, 2017 - Vermont Agency of Transportation (VTrans) is moving forward to replace the VT Route 2B Bridge 6 over the Lamoille Valley Rail Trail in the Town of St. Johnsbury. The bridge is less than one half mile west of Route 2B's eastern intersection with US Route 2.

Accelerated bridge construction methods will be used to shorten the length of time to build the new bridge. A 50-day bridge closure period, at the construction site, is planned while the existing bridge is demolished and the new bridge is constructed. Both the bridge and Lamoille Valley Rail Trail closure periods are expected to start on **May 10th, 2017**. The Lamoille Valley Rail Trail is expected to re-open after overhead work is completed in mid-June.

Separate offsite detours for vehicles and trail users will be marked with signs for use during the closure period. VT 2B through traffic will be directed to use US 2 as a detour route around the project. Rail trail users will be directed to use town roads as designated by the Town of St. Johnsbury.

J.P Sicard of Barton, VT was the low bid contractor who was awarded this project. Construction is expected to be completed by the end of July 2017.

For more information, visit the project website at <http://stj2bbridge.vtransprojects.vermont.gov/>

Detour Route

VT Route 2B Bridge 6 over the Lamoille Valley Rail Trail
St. Johnsbury

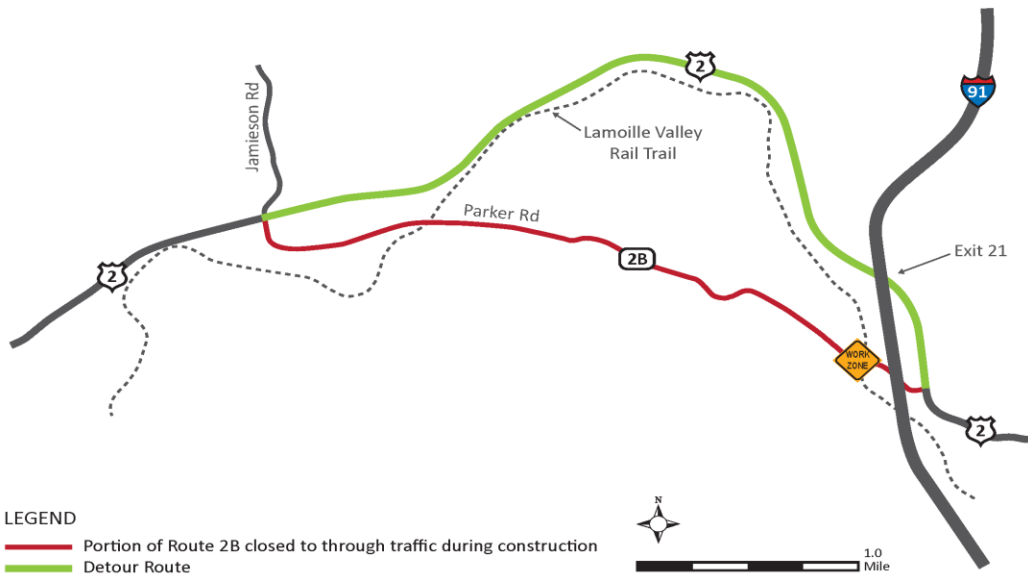

Town of St. Johnsbury's Designated Rail Trail Detour Route

VT Route 2B Bridge 6 over the Lamoille Valley Rail Trail
St. Johnsbury

