

Lake Encroachment Permit Application

Under Chapter 11 of Title 29, § 401 *et seq.*



Application Number:

For Lake Encroachment Permitting Use Only 3170-LEP

Submission of this application constitutes notice that the person in Section D intends to encroach beyond the mean water level of a lake or pond, and certifies that the project will comply with Chapter 11 of Title 29, § 401 *et seq.* All information required on this form must be provided, and the requisite fees (Section H) must be submitted made payable to the State of Vermont.

A. Project Information

1. Physical Address (911 Address – if applicable):

2a. Town - County:

2b. Zip:

3a. SPAN (###-###-##### – if applicable):

(School Parcel Account Number can be obtained from your property tax bill or from your Town Clerk)

3b. Project coordinates (decimal degrees, can be found on Google Maps) Latitude:

Longitude:

4. Name of Lake/Pond:

5a. Have you ever applied for a permit with the Agency of Natural Resources associated with this parcel? Yes No

5b. If yes, please describe (e.g., Wetlands, Act 250, Wastewater, etc.):

6a. Is this application for a Lake Encroachment permit amendment? Yes No

6b. What is the original Lake Encroachment permit number?

6c. Amendment type? Major Minor

If no, skip 6b and 6c.

B. Project Description

1. Describe the proposed project including the materials and equipment that may be used during construction. Please include: **(a)** volume of fill added and/or removed; **(b)** dimensions of proposed project; **(c)** distance beyond mean water level the project will extend; and **(d)** linear feet of shoreline impacted. If this project is to remove and replace an existing encroachment, please include the dimensions of the existing structure.

2. Describe the purpose of the proposed project:

3. Describe what less intrusive feasible alternatives have been considered:

4. Describe the public benefits of the proposed project (e.g., erosion control, improvements to boating/swimming/fishing, public access, etc.):

C. Encroachment Effects

1. What measures are proposed to minimize the project's effects on water quality (e.g., use of a turbidity curtain during construction, heavy equipment will work from shore, etc.)?

2. How will the project minimize effects to fish and wildlife habitat (e.g., construction of the project that disturbs the lakebed will not occur during spring fish spawning (March 15 – July 1))?

3. Does the project propose removal of aquatic or shoreline vegetation? If removing shoreline vegetation (e.g., trees, shrubs, groundcover, duff layer), a Shoreland Protection Permit may be needed.

4. Describe the surrounding shoreline. What measures are proposed to ensure the project is consistent with the surroundings?

5. Will the project impact navigation, recreation, or other public uses? If so, how will these effects be minimized?

D. Applicant/Landowner Information and Certification

If applicable, all landowners must sign the application. Submit additional pages if necessary.

1. Name: Bruce/Marilyn Heinrich & Christine Heinrich

2a. Mailing Address: 600 cormier rd

2b. Town: Danville

2c. State: VT

2d. Zip: 05828

3. Phone: 8027457558

4. Email: chrissieheinrichvt@me.com

5a. Have you completed the voluntary [Natural Shoreland Erosion Control Certification](#) course?☐ Yes☒ No

5b. If yes, please include the location and year you attended the course:

A [list of certified contractors](#) is available online.**Applicant/Landowner Certification:**

As **APPLICANT**, I hereby certify that the statements presented on this application are true and accurate and recognize that by signing this application, I agree to complete all aspects of the project as authorized. I understand that failure to comply with the foregoing may result in violation of the Chapter 11 of Title 29, § 401 *et seq.*, and the Vermont Agency of Natural Resources may bring an enforcement action for violations of the Act pursuant to 10 V.S.A. chapter 201.

Applicant/Landowner Signature:

Christine Heinrich

Date: 07/18/2020

E. Application Preparer Information and Certification (check box if same as Section D. ☒)

1. Name: Christine Heinrich

2a. Mailing Address: 600 Cormier rd

2b. Town: Danville

2c. State: VT

2d. Zip: 05828

3. Phone: 8027457558

4. Email: chrissieheinrichvt@me.com

5a. Have you completed the voluntary [Natural Shoreland Erosion Control Certification](#) course?☐ Yes☒ No

5b. If yes, please include the location and year you attended the course:

A [list of certified contractors](#) is available online.**Application Preparer Certification:**

As **APPLICATION PREPARER**, I hereby certify under penalty of law that this document and all attachments were prepared under my direction or supervision in accordance with a system designed to assure that qualified personnel properly gathered and evaluated the information submitted. Based on my inquiry of the person or persons who manage the system, or those persons directly responsible for gathering the information, the information submitted is, to the best of my knowledge and belief, true, accurate, and complete. I am aware that there are significant penalties for submitting false information, including the possibility of fine and imprisonment for knowing violations.



Check this box to request co-applicant status. By checking this box, you will be considered a co-permittee and are responsible for the conditions of the permit. Co-permittee status will likely be required for any individual or entity other than the permittee for construction based/lakebed disturbing encroachments (e.g., shoreline stabilization, dredging, boathouse repair, concrete wall/dock repair, etc.).

Application Preparer Signature:

Christine Heinrich

Date: 7/18/2020

F. Adjoining Property Owner Notification (For additional information, please see the [Adjoining Property Owner Notification Guidance](#))*CH*

I certify, by initialing to the left, that I have notified adjoining property owners of the proposed project using the [letter](#) template sent by U.S. Mail.

G. Additional Required Documentation *(Please check the box to ensure you have completed the following)*

All sections of the application are complete or otherwise indicate "not applicable"

Application includes site plans with dimensions

Project description includes distance beyond mean water level the project will extend

Application includes photos of project area

H. Permit Application Fees

Select the most applicable permit description(s) and requisite fee(s). If the proposed project involves more than one of the project types, multiple fees may apply. For example, a project involving structural shoreline stabilization and marina improvement will require both fees (2) and (3).

1. Non-structural erosion control project (e.g., sloped, dry-laid rip rap):

Administrative Processing Fee: \$155.00

Total:

2. Structural erosion control project (e.g., vertical wall replacement)

Administrative Processing Fee: \$250.00

Total:

3. Other Projects (e.g., marina improvements, boathouse repair, dredging):

Administrative Processing Fee: \$300.00

Application Review Fee: 1% of Total Project Cost

(\$20,000 max fee, check box if project cost is over \$2,000,000)

Enter the Total Project Cost:

\$ _____

Total Fee:

Refund Policy:

- If an application is modified, withdrawn or denied after technical review has commenced; all fees are retained.
- If an application is withdrawn prior to administrative review; all fees will be refunded.
- If an application is withdrawn after administrative review but prior to commencement of technical review, deemed administratively incomplete and returned to applicant, or determined that a permit is not required; administrative fees are retained and permit application review fees will be refunded.

Application Submittal:

Submit this form and appropriate fee, payable to:

State of Vermont – Vermont Department of Environmental Conservation

Watershed Management Division – Shoreland Permitting

1 National Life Drive, Davis 3

Montpelier, VT 05620-3522

D. Applicant/Landowner Information and Certification

If applicable, all landowners must sign the application. Submit additional pages if necessary.

1. Name: Bruce/Marilyn Heinrich & Christine Heinrich

2a. Mailing Address: 600 cormier rd

2b. Town: Danville

2c. State: VT

2d. Zip: 05828

3. Phone: 8027457558

4. Email: chrissieheinrichvt@me.com

5a. Have you completed the voluntary [Natural Shoreland Erosion Control Certification](#) course? ☐ Yes ☒ No

5b. If yes, please include the location and year you attended the course:

A [list of certified contractors](#) is available online.**Applicant/Landowner Certification:**

As **APPLICANT**, I hereby certify that the statements presented on this application are true and accurate and recognize that by signing this application, I agree to complete all aspects of the project as authorized. I understand that failure to comply with the foregoing may result in violation of the Chapter 11 of Title 29, § 401 *et seq.*, and the Vermont Agency of Natural Resources may bring an enforcement action for violations of the Act pursuant to 10 V.S.A. chapter 201.

Applicant/Landowner Signature:

Christine Heinrich

Date: 07/18/2020

E. Application Preparer Information and Certification (check box if same as Section D. ☒)

1. Name: Christine Heinrich

2a. Mailing Address: 600 Cormier rd

2b. Town: Danville

2c. State: VT

2d. Zip: 05828

3. Phone: 8027457558

4. Email: chrissieheinrichvt@me.com

5a. Have you completed the voluntary [Natural Shoreland Erosion Control Certification](#) course? ☐ Yes ☒ No

5b. If yes, please include the location and year you attended the course:

A [list of certified contractors](#) is available online.**Application Preparer Certification:**

As **APPLICATION PREPARER**, I hereby certify under penalty of law that this document and all attachments were prepared under my direction or supervision in accordance with a system designed to assure that qualified personnel properly gathered and evaluated the information submitted. Based on my inquiry of the person or persons who manage the system, or those persons directly responsible for gathering the information, the information submitted is, to the best of my knowledge and belief, true, accurate, and complete. I am aware that there are significant penalties for submitting false information, including the possibility of fine and imprisonment for knowing violations.

☐ Check this box to request co-applicant status. By checking this box, you will be considered a co-permittee and are responsible for the conditions of the permit. Co-permittee status will likely be required for any individual or entity other than the permittee for construction based/lakebed disturbing encroachments (e.g., shoreline stabilization, dredging, boathouse repair, concrete wall/dock repair, etc.).

Application Preparer Signature:

Christine Heinrich

Date: 7/18/2020

F. Adjoining Property Owner Notification (For additional information, please see the [Adjoining Property Owner Notification Guidance](#))

CH I certify, by initialing to the left, that I have notified adjoining property owners of the proposed project using the [letter](#) template sent by U.S. Mail.

SEA WALL PLAN

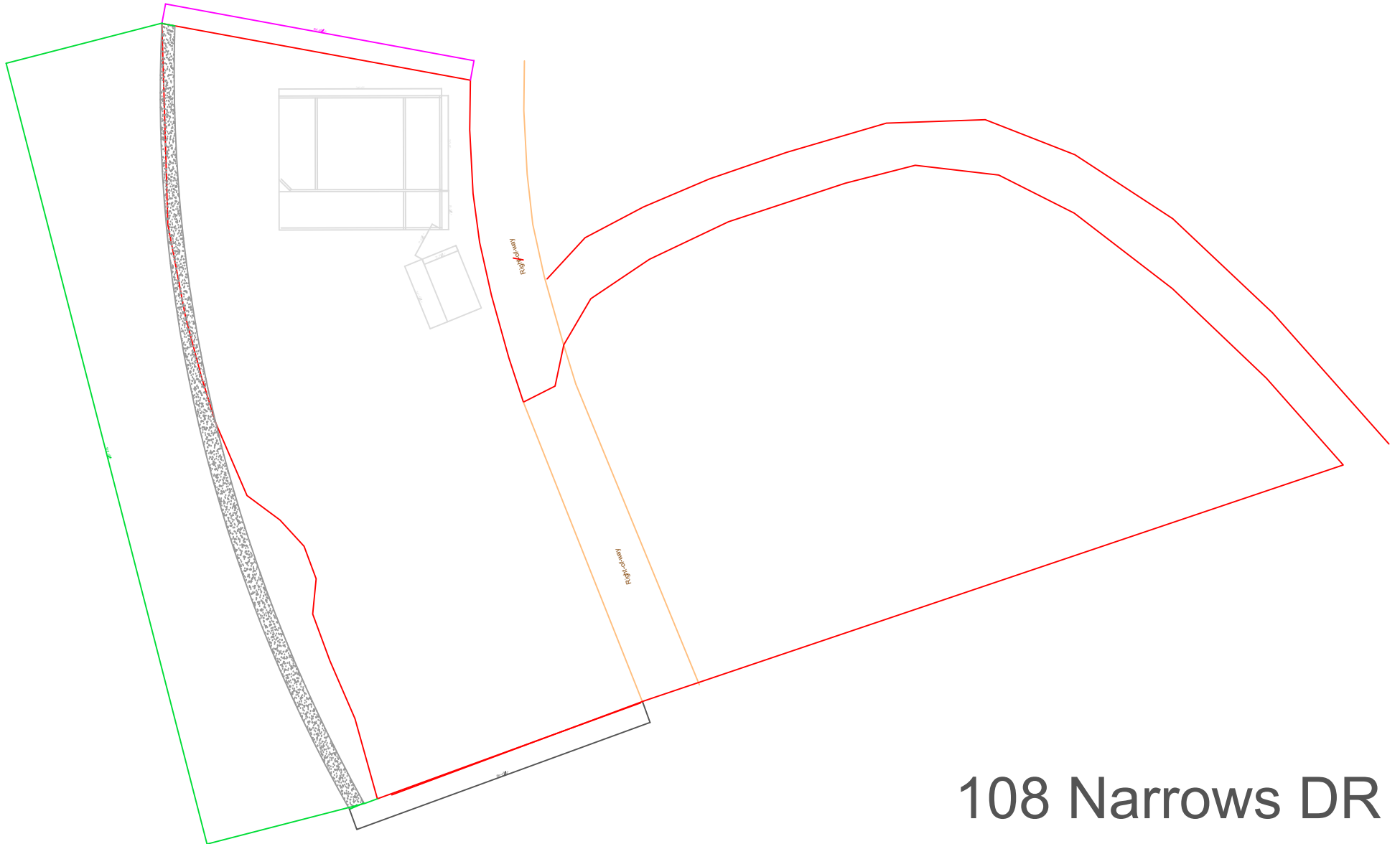

108 Narrows DR
West Danville, VT